

established 200 years

Tayler & Fletcher



Maple House 18B Shipton Road
Ascott-Under-Wychwood, OX7 6AF
Guide Price £975,000



Maple House 18B Shipton Road

Ascott-Under-Wychwood, OX7 6AF

Nestled on the charming Shipton Road in the picturesque village of Ascott-Under-Wychwood, this modern detached house offers a perfect blend of comfort and style. Built in 2005, the property boasts a spacious layout, making it an ideal family home.

With four well-proportioned bedrooms and a study, there is ample space for family living or hosting guests. The three bathrooms ensure convenience for all, providing both privacy and comfort. The two inviting reception rooms offer versatile spaces that can be tailored to your needs, whether for relaxation, entertaining, or family gatherings.

LOCATION

Ascott-under-Wychwood is an attractive residential village, on the edge of the Cotswolds and is in an area of 'Outstanding Natural Beauty' in the Evenlode Valley. The village has a parish church, village hall with lots of clubs & social events, small private school, community shop and public house. It is well placed for Burford and Chipping Norton (both about 5 miles), Witney (6 miles), Oxford and Banbury (about 20 miles each) and Cheltenham (27miles) Main line trains (Paddington/Worcester) are available only 3 miles away at Charlbury. Ascott forms part of the 'The Wychwoods', thriving West Oxfordshire villages in the Cotswolds Area of Outstanding Natural Beauty. Shipton provides a range of local amenities including a village shop and post office, petrol station, The Wychwood Inn, The Lamb Inn and The Shaven Crown Hotel. Shipton also has a primary school, village hall and doctors surgery and there are further shops and services including a dentist and library in nearby Milton-under-Wychwood. A wider range of facilities may be found in the nearby market towns of Burford and Chipping Norton, while the area's larger commercial centres of Witney, Oxford and Cheltenham are within easy travelling distance with access to the motorway network via the A40 and the

DESCRIPTION

M4 to the south. There are main line rail services to London Paddington (80 minutes) from Charlbury and a request stop in the village itself.

Beautifully presented and well maintained detached four bedroom family house with flexible well proportioned accommodation. The property was built 20 years ago by well known local builders, Empire Homes to an extremely high standard throughout. Features include under floor heating to the ground and individually zoned areas with heating controls, replacement windows and doors, re-fitted bathrooms and surround sound to ground floor. The outside space has been recently landscaped and has wealth of mature shrubs and plants. There is a double garage with parking for two cars outside.

ACCOMMODATION

GROUND FLOOR

Canopy porch with front door to

Entrance Hall - with stairs to first floor, under stairs cupboard, wooden flooring and door to

Sitting Room - Double aspect room with Bi-Fold doors to rear garden, wooden flooring, feature fireplace (currently not





in use)

Dining Room/Family Room - wooden flooring, double aspect.

Cloakroom - WC and basin.

Kitchen/Diner - Fitted with a range of units including integrated appliances, wooden flooring, windows and door to rear.

Utility - with plumbing for washing machine, sink, gas fired boiler, door to side.

FIRST FLOOR

Galleried Landing - window to front.

Principle Bedroom - With window to front and side, walk in dressing room with shelving, door to Ensuite.

Guest Bedroom (2) - window to front, door to Ensuite.

Bedroom 3 - window to rear.

Bedroom 4 - window to rear.

Study - window to side.

Family Bathroom - Bath, shower, WC and basin.

OUTSIDE

To the front of the property is a double garage with electric up and over door to front, pedestrian door to rear, power and light.

Parking to the front of the garage. Mature flowers with plants and shrubs.

To the side of the property is pedestrian gated access leading to the rear garden which has recently been landscaped and

includes tiled patio areas and mature shrubs and plants.

FIXTURES & FITTINGS

Only those specifically mentioned within the sale particulars are included in the sale. Please note that we have not tested the equipment, appliances and services in this property. Interested applicants are advised to commission the appropriate investigations before formulating their offer to purchase.

SERVICES

Mains Gas, Electricity, Water and Drainage are connected. Gas-fired central heating.

LOCAL AUTHORITY

West Oxfordshire District Council
Woodgreen
Witney
Oxfordshire
OX28 6NB
(Tel: 01993 861000)
www.westoxon.gov.uk

COUNCIL TAX

Council Tax band F. Rate Payable for 2025/ 2026 £3448.58

VIEWING

Viewing is strictly via the Sole Agents Tayler and Fletcher and prospective purchasers should satisfy themselves as to the accuracy of any particular point of interest before journeying to view.

Floor Plan

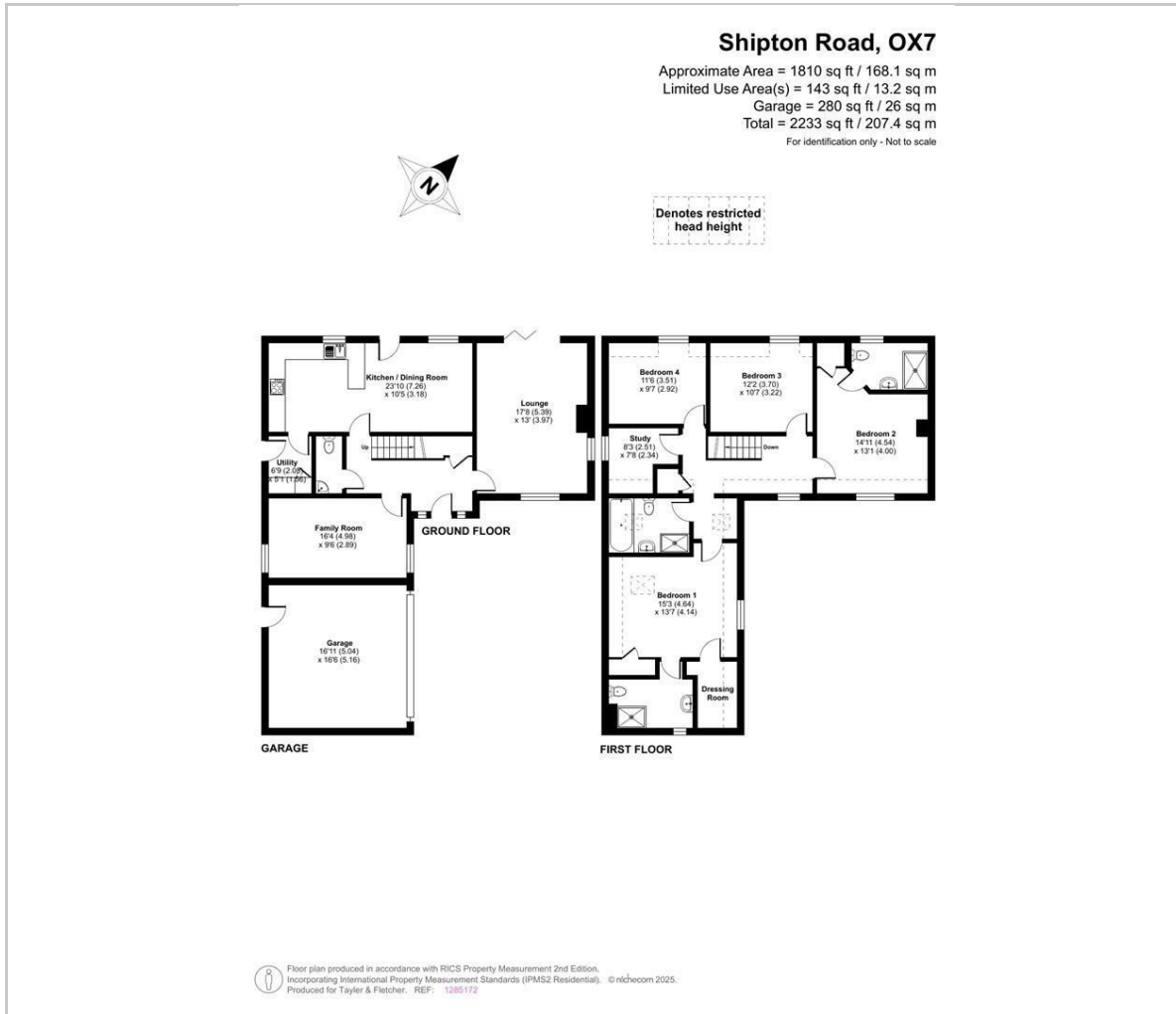

Area Map

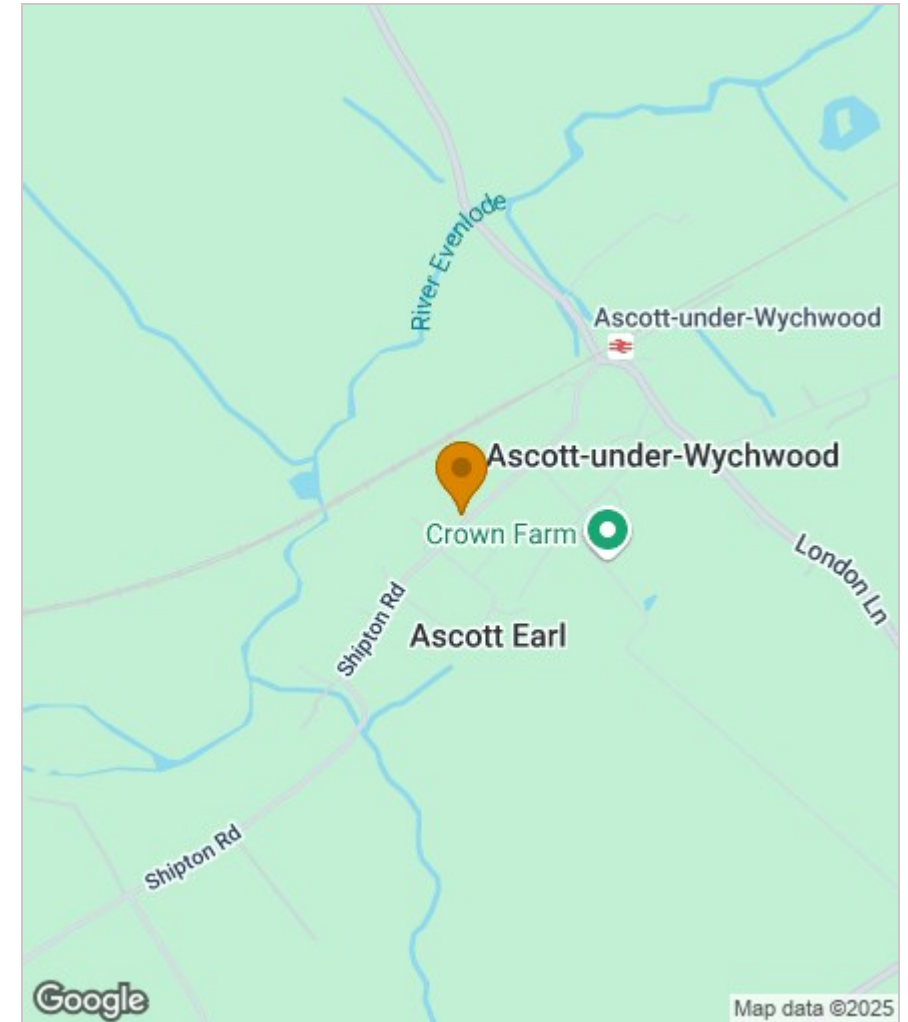

Viewing

Please contact our Chipping Norton Sales Office on 01608 644344 if you wish to arrange a viewing appointment for this property or require further information.

These particulars, whilst believed to be accurate are set out as a general outline only for guidance and do not constitute any part of an offer or contract. Intending purchasers should not rely on them as statements of representation of fact, but must satisfy themselves by inspection or otherwise as to their accuracy. No person in this firm's employment has the authority to make or give any representation or warranty in respect of the property.

